

SHOWCASE HOME | PEAR

CRESSWIND®

Street Address: 14 OZARK WAY

A/C Sq. Ft.: 2,390

Bedrooms: 3

Bathrooms: 3

Move-In Date: April 2024

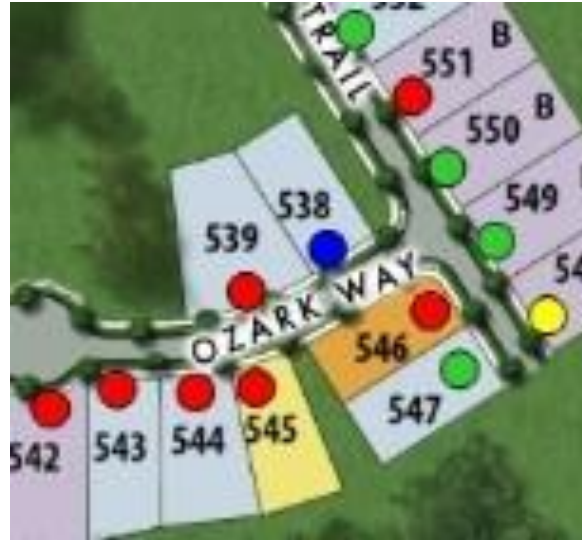

ELEVATION: AB

HOMESITE: 538

Cresswind Twin Lakes | 118 Hartwell Court, Hoschton, GA 30548



©2022. Prices, homesites, amenities, home designs, square footage and other information subject to errors, changes, omissions, deletions, availability, prior sales and withdrawal at any time without notice. Square footage numbers are approximate and may vary depending on the standard measurement used. Photos and/or drawings of homes may show upgraded landscaping and may not represent the lowest priced homes in the community. All renderings and floorplans in these materials are an artist's conceptual drawings and will vary from the actual plans and homes as built. CGC1509406

KOLTERHOMES®

SHOWCASE HOME FLOORPLAN

PEAR

3 Bedroom, 3 Bath, Den, Great Room, Covered, Screened Lanai, 3-Car Garage and Unfinished Bonus

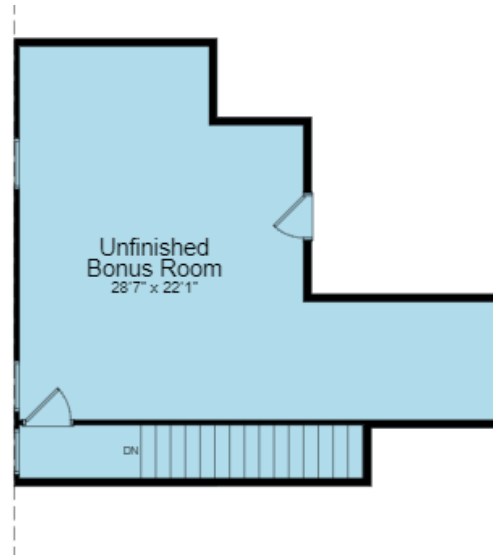
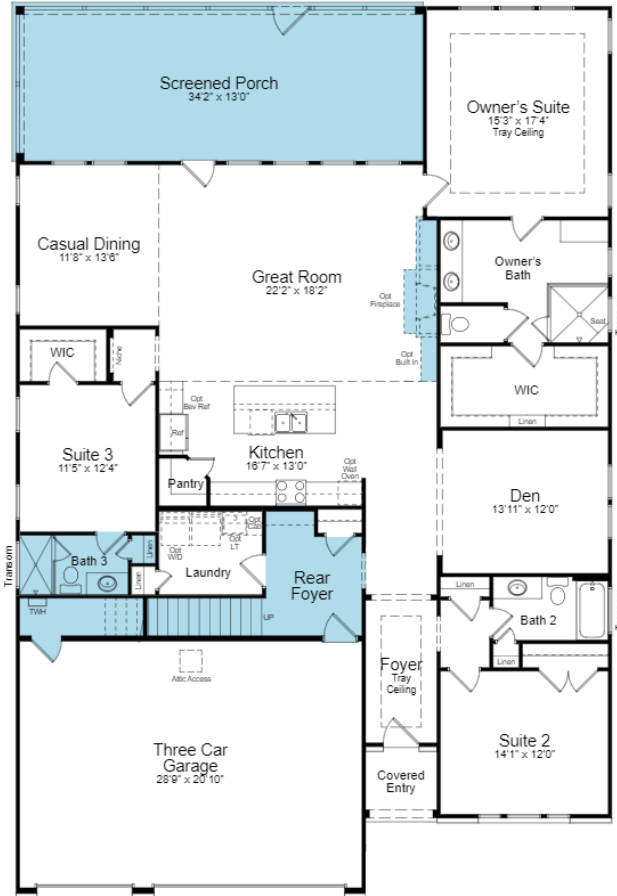

Cresswind Twin Lakes | 118 Hartwell Court, Hoschton, GA 30548



SHOWCASE HOME FEATURE HIGHLIGHTS

KITCHEN DETAILS

- 30" gas 5-burner cooktop
- Cabinet crown molding
- Quartz countertops
- LVP flooring
- Under Cabinet Lighting
- Stainless Steel Single Bowl Undermount Sink

DESIGNER FEATURES

- 4 FT. garage extension
- Frameless shower in owner's bath
- Laundry Room with wall cabinets and laundry sink
- Gourmet kitchen
- Direct vent fireplace
- Screened Lanai
- Unfinished Bonus Room

Cresswind Twin Lakes| 118 Hartwell Court, Hoschton, GA 30548



SHOWCASE HOME DESIGNER FEATURES | KITCHEN



**LEVEL 4 KAYES CABINETS
WHITE**



MOEN ARBOR FAUCET



**LEVEL 3 QUARTZ COUNTERTOP
BLANCO ORION**



**CATCH ICE WHITE 3X6
HERRINGBONE
BACKSPLASH**

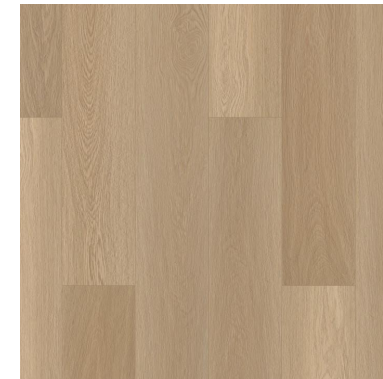

**LVP FLOORING
POLARIS PLUS / CASTAWAY**

Cresswind Twin Lakes | 118 Hartwell Court, Hoschton, GA 30548



SHOWCASE HOME DESIGNER FEATURES | KITCHEN APPLIANCES

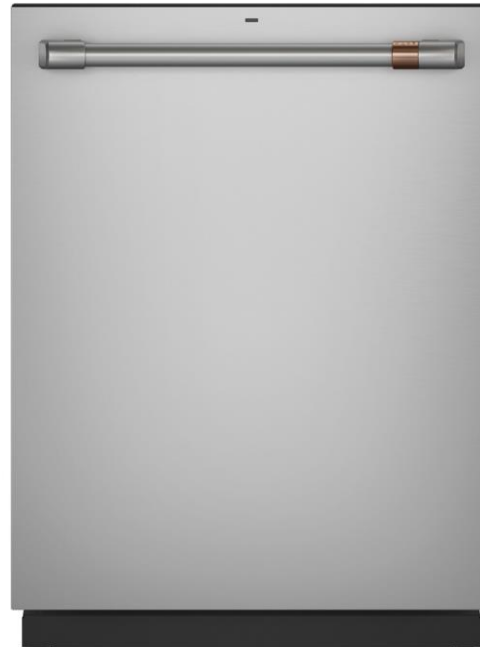

Cresswind Twin Lakes | 118 Hartwell Court, Hoschton, GA 30548



©2022. Prices, homesites, amenities, home designs, square footage and other information subject to errors, changes, omissions, deletions, availability, prior sales and withdrawal at any time without notice. Square footage numbers are approximate and may vary depending on the standard measurement used. Photos and/or drawings of homes may show upgraded landscaping and may not represent the lowest priced homes in the community. All renderings and floorplans in these materials are an artist's conceptual drawings and will vary from the actual plans and homes as built. CGC1509406

KOLTERHOMES[®]

SHOWCASE HOME DESIGNER FEATURES | OWNERS BATH



**LEVEL 4
CABINETS –
KAYES
WHITE**



**MOEN VOSS
SINGLE LEVER
BRUSHED
NICKEL**



**SILESTONE
QUARTZ-
ARIEL**

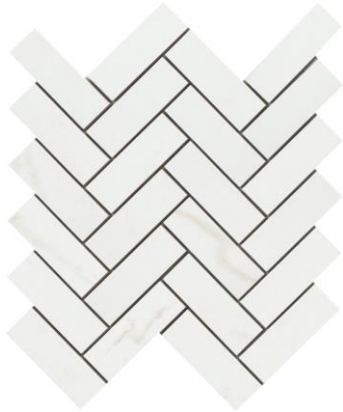

SHOWER FLOOR



**CONTESSA ORO MATTE
SHOWER WALLS AND
BATHROOM FLOOR**

Cresswind Twin Lakes | 118 Hartwell Court, Hoschton, GA 30548



SHOWCASE HOME DESIGNER FEATURES | BATH 2



**LEVEL 4
CABINETS
KAYES
WHITE**



**ARIEL
SILESTONE
QUARTZ**

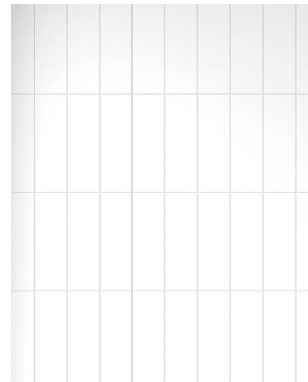

**SHOWER WALL TILE
CRAFT GLOSSY 3X12**

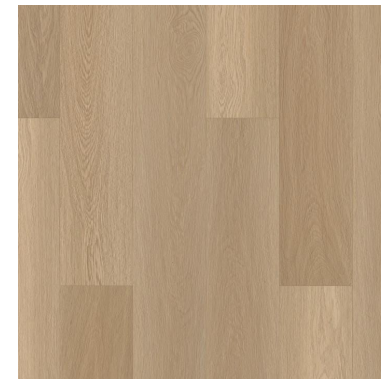

**BATHROOM FLOOR
POLARIS PLUS - CASTAWAY**



**MOEN VOSS
SINGLE LEVER
BRUSHED
NICKEL**

Cresswind Twin Lakes | 118 Hartwell Court, Hoschton, GA 30548



SHOWCASE HOME DESIGNER FEATURES | BATH 3



**LEVEL 4
CABINETS
KAYES
WHITE**



**ARIEL
SILESTONE
QUARTZ**



**MOEN VOSS
SINGLE LEVER
BRUSHED NICKEL**



**SHOWER WALL AND BATHROOM FLOOR TILE
CONTESSA ORO 12X24**

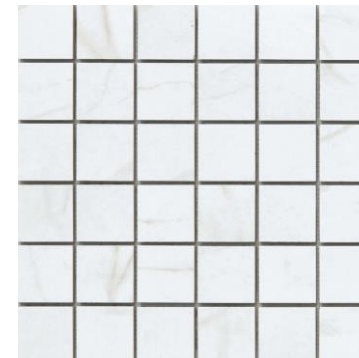

Cresswind Twin Lakes| 118 Hartwell Court, Hoschton, GA 30548



SHOWCASE HOME DESIGNER FEATURES MAIN LEVEL - GENERAL FINISHES

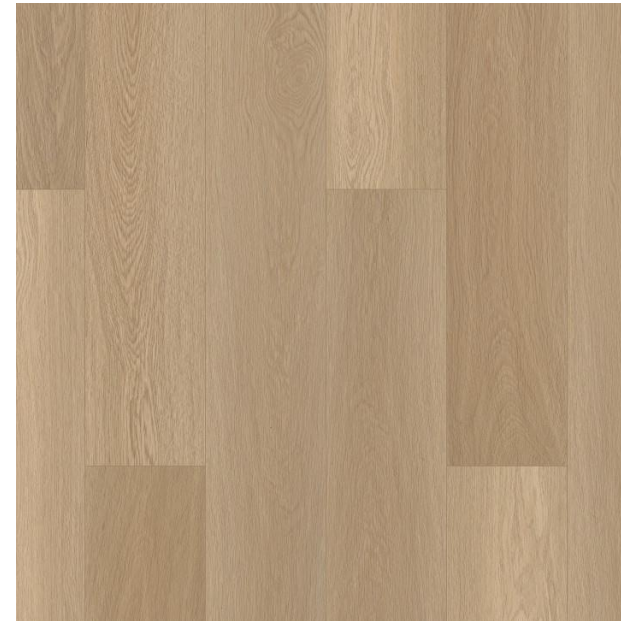
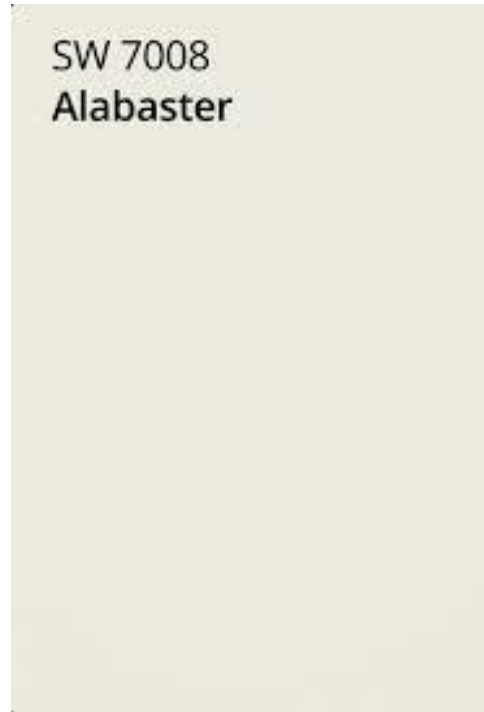

**EVP FLOORING
POLARIS PLUS
CASTAWAY**

Cresswind Twin Lakes| 118 Hartwell Court, Hoschton, GA 30548



©2022. Prices, homesites, amenities, home designs, square footage and other information subject to errors, changes, omissions, deletions, availability, prior sales and withdrawal at any time without notice. Square footage numbers are approximate and may vary depending on the standard measurement used. Photos and/or drawings of homes may show upgraded landscaping and may not represent the lowest priced homes in the community. All renderings and floorplans in these materials are an artist's conceptual drawings and will vary from the actual plans and homes as built. CGC1509406

KOLTERHOMES[®]

SHOWCASE HOME DESIGNER FEATURES | LIGHTING MAIN LEVEL

P4638-09



P2018-09



P3799-09



P2021-09

Cresswind Twin Lakes | 118 Hartwell Court, Hoschton, GA 30548

