

SHOWCASE HOME | JULIA



Street Address:	3023 Lake Como Drive				
A/C Sq. Ft.:	1,958				
Bedrooms:	2	Bathrooms:	2	Move-In Date:	Immediate



ELEVATION: C

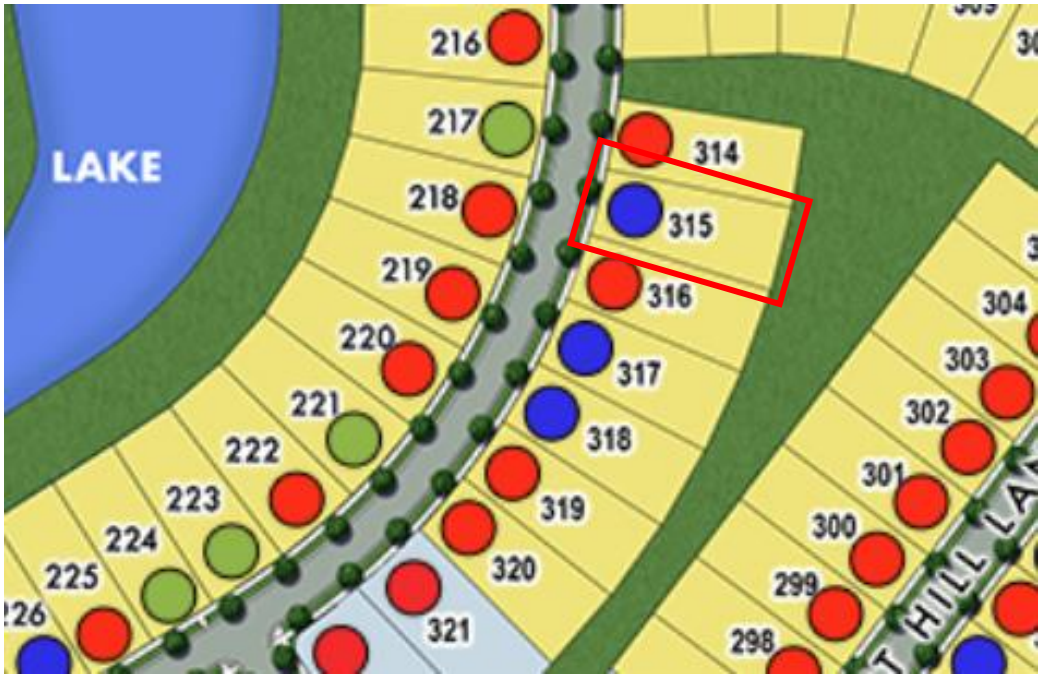

HOMESITE: 315

Exterior Color Package 3: *Lost in Gray Siding, Thunder Gray Front Door, Tuxedo Gray Shutters, Weathered Wood Roofing.*

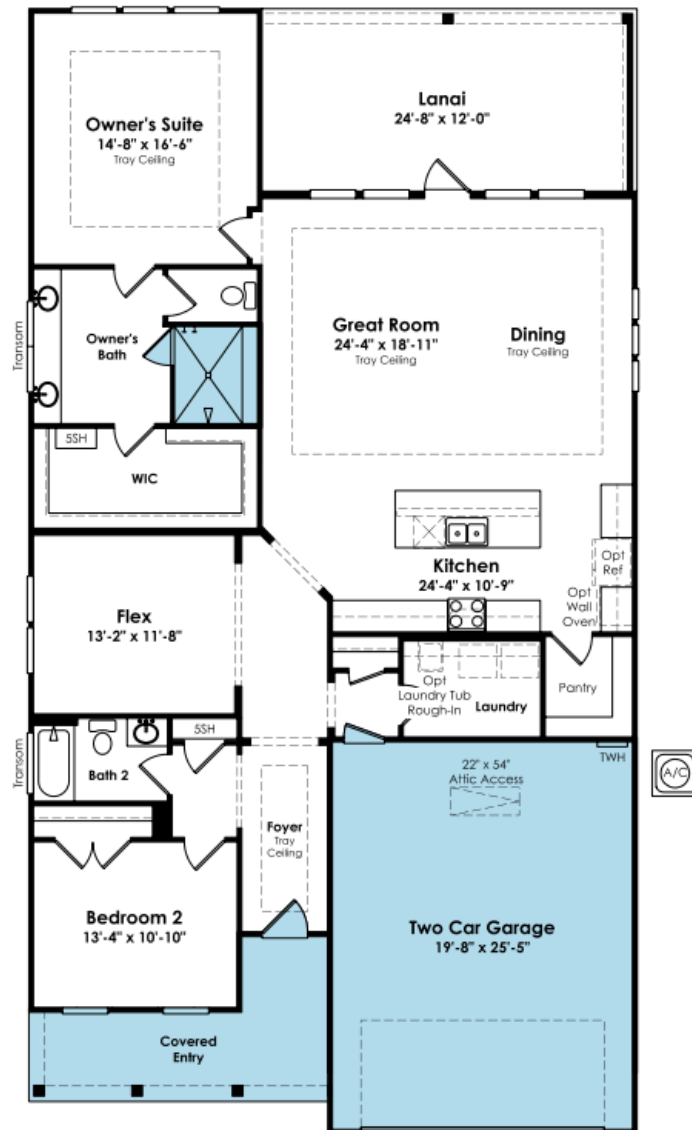

SHOWCASE HOME FLOORPLAN

JULIA

2 Bedroom, 2 Full Bath, Owners' Deluxe Shower with Shower Head & Rain Head, Floor Outlet in Great Room, Utility Tub-Rough In Only in Laundry Room, 5' Privacy Wall on Covered Lanai, 4' Garage Extension.

SHOWCASE HOME FEATURE HIGHLIGHTS

KITCHEN DETAILS

- CHEF Kitchen Cabinet & Appliance Package- Upgraded Cabinets, Cooktop Cabinet w/ Drawers, Built-In Refrigerator Facade, Crown Molding, Double Trash Roll-out
- GE Profile Appliances: 36" Gas Cooktop ILO Electric Cooktop, 36" Pro-Style Canopy Hood, Built-in Microwave Oven with Trim Kit and Wall Oven in Tower Cabinet, Dishwasher
- Upgraded Quartz Countertops
- Farmhouse Cast Iron Kitchen Sink
- Under Kitchen Cabinet Lighting with Switch

DESIGNER FEATURES

- Owners' Deluxe Shower with Shower Head & Rain Head & Oversized Bench
- Floor Outlet in Great Room
- Utility Tub-Rough In Only in Laundry Room
- 5' Privacy Wall on Covered Lanai
- 4' Garage Extension
- Shaw EVP Flooring throughout home with Tile in Owners' Bathroom and Carpet in Bedroom 2



SHOWCASE HOME DESIGNER FEATURES | KITCHEN



SHOWCASE HOME DESIGNER FEATURES OWNER'S BATH



SHOWCASE HOME DESIGNER FEATURES | BATH II



SHOWCASE HOME DESIGNER FEATURE | FLOORING

