

SHOWCASE HOME | Caroline

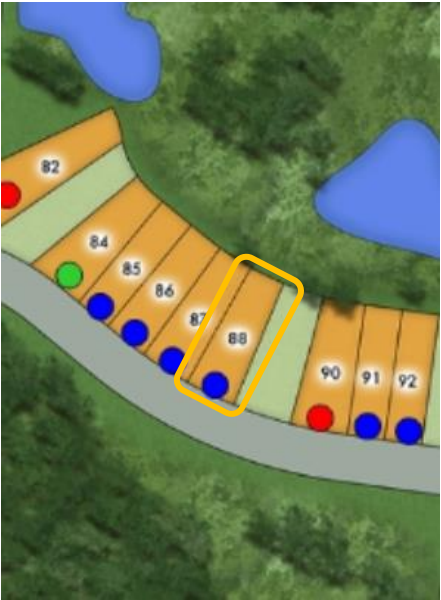

Street Address:	415 SE Via Sangro				
A/C Sq. Ft.:	1,788				
Bedrooms:	3	Bathrooms:	2	Move-In Date:	Immediate



ELEVATION: A

HOMESITE: 088

Exterior Color Package: Exterior Color Package A7 - Transitional Scheme 7 - Exterior Body: SW 7006 Extra White - Trim: SW 7006 Extra White - Garage Door: SW 7069 Iron Ore - Front Entry Door: SW 7069 Iron Ore - Fascia: SW 7006 Extra White - Roof Color: Eagle - Belair, Sierra Madre 4503 - Paver Color: 4x8 Slate Herringbone - Windows: Bronze - Gutters: Eggshell

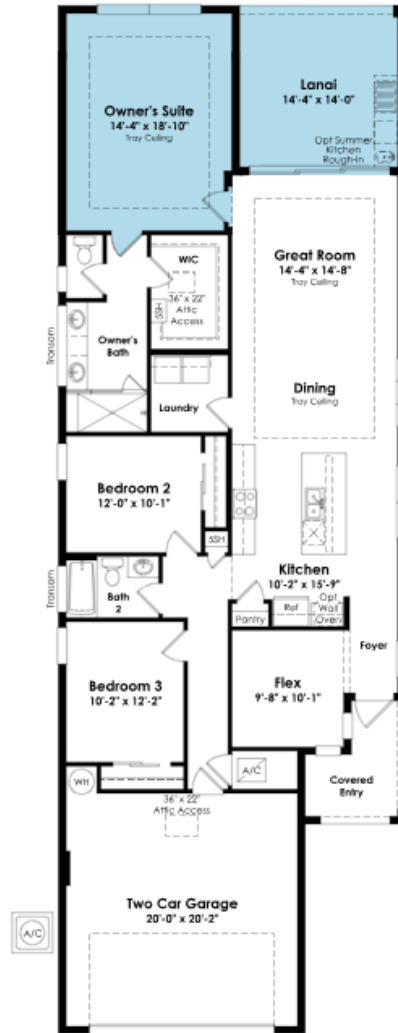

SHOWCASE HOME FLOORPLAN

THE CAROLINE

3 Bedroom, Flex, 2 Full Bath, Great Room,
Covered Lanai and 2-Car Garage

SHOWCASE HOME FEATURE HIGHLIGHTS

KITCHEN DETAILS

- GOURMET Kitchen
- Cabinet Crown Moulding
- 42" Upgraded Cabinets
- Cambria WhiteCliff Square Quartz Countertops
- Emser 24x24 Tile
- Single Bowl Undermount Sink

DESIGNER FEATURES

- 12x10 Sliding Glass Doors
- 4' Owner's Suite & Lanai Extension
- 24x24 Tile All Throughout
- Frameless Shower in Owner's Bath
- Upgraded Lighting Package Throughout
- Cabinets in Laundry Room
- 5' Privacy Wall on Covered Lanai

DESIGN PHOTOS | KITCHEN

CABINETS

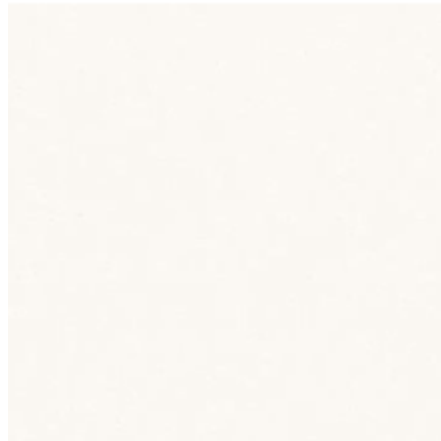
COUNTERTOP
QUARTZ

White Cliff – QTZ L3

BACKSPLASH

MAIN
FLOORINGCABINET
HARDWARE

BP36872-CZ



BP36873-CZ

FAUCET



SINK



DESIGN PHOTOS | OWNERS BATH

CABINETS



**COUNTERTOP
QUARTZ**

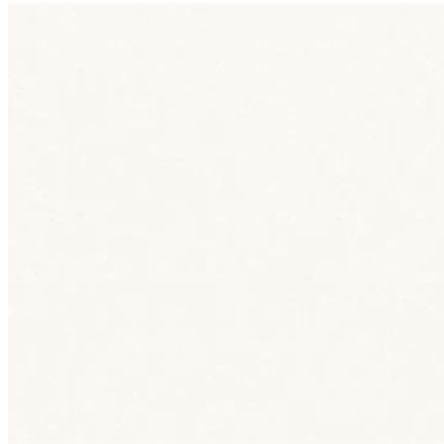

White Cliff – QTZ L3

FLOORING



WALL TILE



**CABINET
HARDWARE**



BP36872-CZ



BP36873-CZ

PLUMBING



SHOWER FLOOR

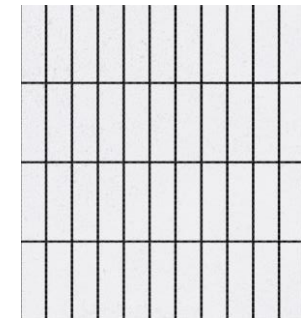

DESIGN PHOTOS | BATH #2

CABINETS

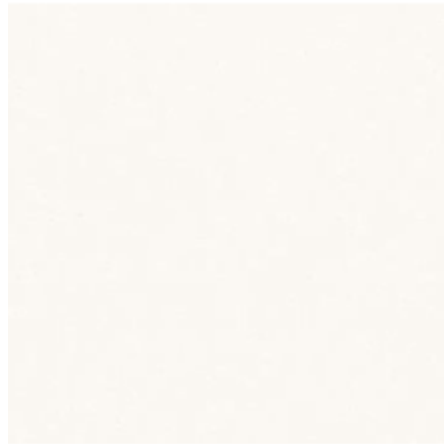
COUNTERTOP
QUARTZ

White Cliff - QTZ L3

FLOORING



WALL TILE

CABINET
HARDWARE

BP36873-CZ

PLUMBING

